

# User Manual for ZD-S Excellence Controller

## Model: ZD-S Excellence

### 1. Overview

- Button Layout
  - Basic Operations
  - Mode Selection & Device Connection
  - Mode Switching
  - Turbo Mode
  - Calibration
  - Back Button Setup
  - Onboard Profile Switching
  - Dual-Stage Trigger Switch
  - Shortcuts in Switch Mode
-



---

## 2. Basic Operations

### 1. Power On

Hold the **Home** button for 1 second to power on.

### 2. Power Off

Hold the **Home** button for 3 seconds to power off.

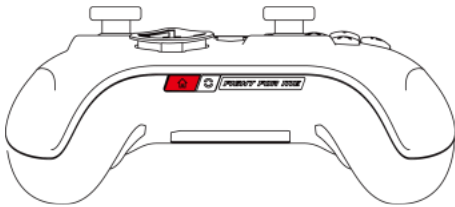

### 3. Auto Sleep

The controller enters sleep and disconnects automatically after **15 minutes** of inactivity.

### 4. Reset

Hold **Back + Mode** for 2 seconds, a vibration indicates a successful reset.

*Note: Joystick/Trigger linear adjustment cannot be reset, enter calibration mode to adjust.*



### 5. Check Battery Level

Check via the official app.

## 6. Charging

- Use a computer USB port for charging.
  - Use a 5V/2A or lower charger.
  - **DO NOT USE** fast chargers, low-quality non-standard adapters, or over-voltage/over-current power supplies.
- 

## 3. Mode Selection & Device Connection

### 1. Wired Connection (PC)

1. Connect the controller to a PC with a data cable.
2. The indicator turns **blue** when connected successfully.

*A data-transfer cable is required.*

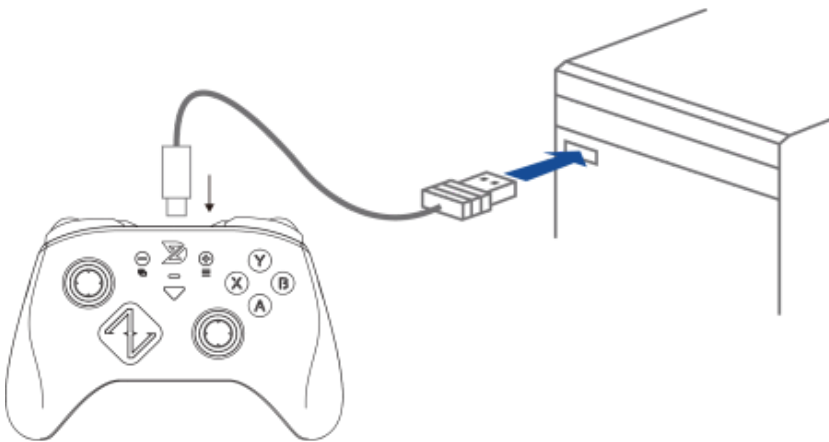

### 2. Official Dongle Connection (PC)

1. Plug the dongle into a PC USB port.
2. Hold **Y + Home** to power on, the indicator flashes **blue**.
3. Wait for automatic connection.

The indicator stays **blue** for 3 seconds, then switches to the custom color.

*(Re-pair if connection fails.)*

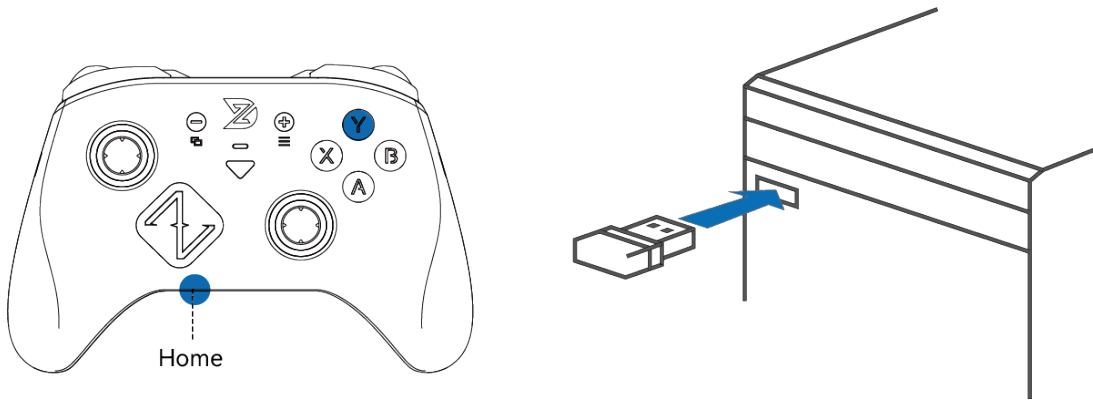

## Re-Pairing

1. When the dongle indicator flashes, press and hold the dongle's **Triangle** button ▽ until it flashes rapidly.
2. Hold **Y + Home** to power on, release when the indicator flashes **blue**.
3. Hold the **Pair** button for 3 seconds, the indicator flashes **blue/yellow** alternately.
4. Wait for connection. The indicator stays **blue** for 3 seconds, then switches to your custom color.

## 3. Bluetooth Connection (Windows 10/11, Android, iOS)

*Not recommended with Bluetooth headsets/speakers, use a wired connection for stability.*

1. Hold **A or B + Home** to power on, release when the indicator flashes green.
2. Hold the **Pair** button for 3 seconds, the indicator flashes **green/yellow** alternately.
3. On your device, search for and connect to: **Xbox Wireless Controller**.
4. The indicator stays **green** for 3 seconds, then switches to your custom color.



## Compatible Devices

- Android (6.0+): phones, tablets, smart TVs, boxes, projectors (TV/box/projector must support the controller).
- iOS (13+): iPhone, iPad.
- PC: Windows 10/11.

## 4. Connection to Nintendo Switch

### Wireless Connection

1. On Switch: go to **Controllers** → **Change Grip/Order**.
2. Hold **X + Home** to power on, release when the indicator flashes **red**.
3. Hold the **Pair** button for 3 seconds; the indicator flashes **red/yellow** alternately.
4. The indicator stays **red** for 3 seconds, then switches to your custom color.

*Paired devices: press **X + Home** to reconnect quickly (Switch 1 only, Switch 2 requires the console to be powered on first).*

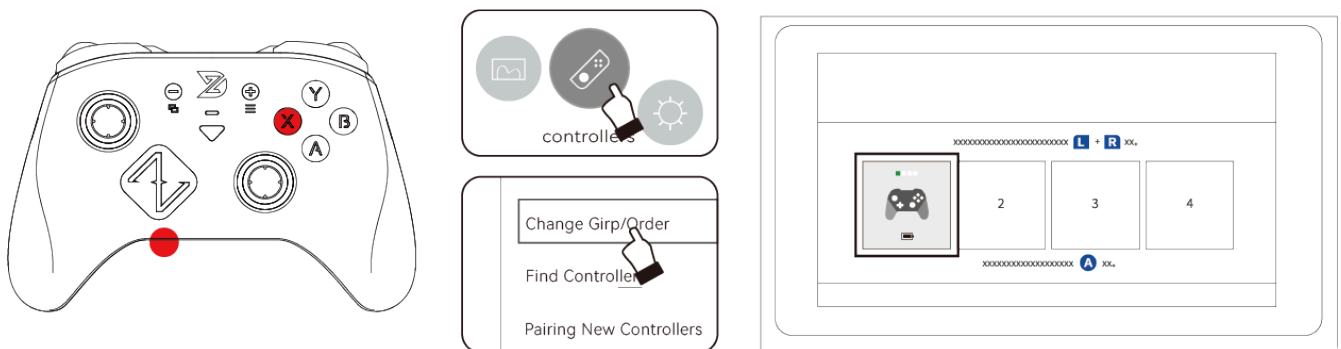

### Wired Connection

1. On Switch: Go to **System Settings** → **Controllers and Sensors** → **Pro Controller Wired Communication** → **ON**.
2. Connect the controller to the console/dock via a data cable.
3. The indicator stays **red** for 3 seconds, then switches to your custom color.

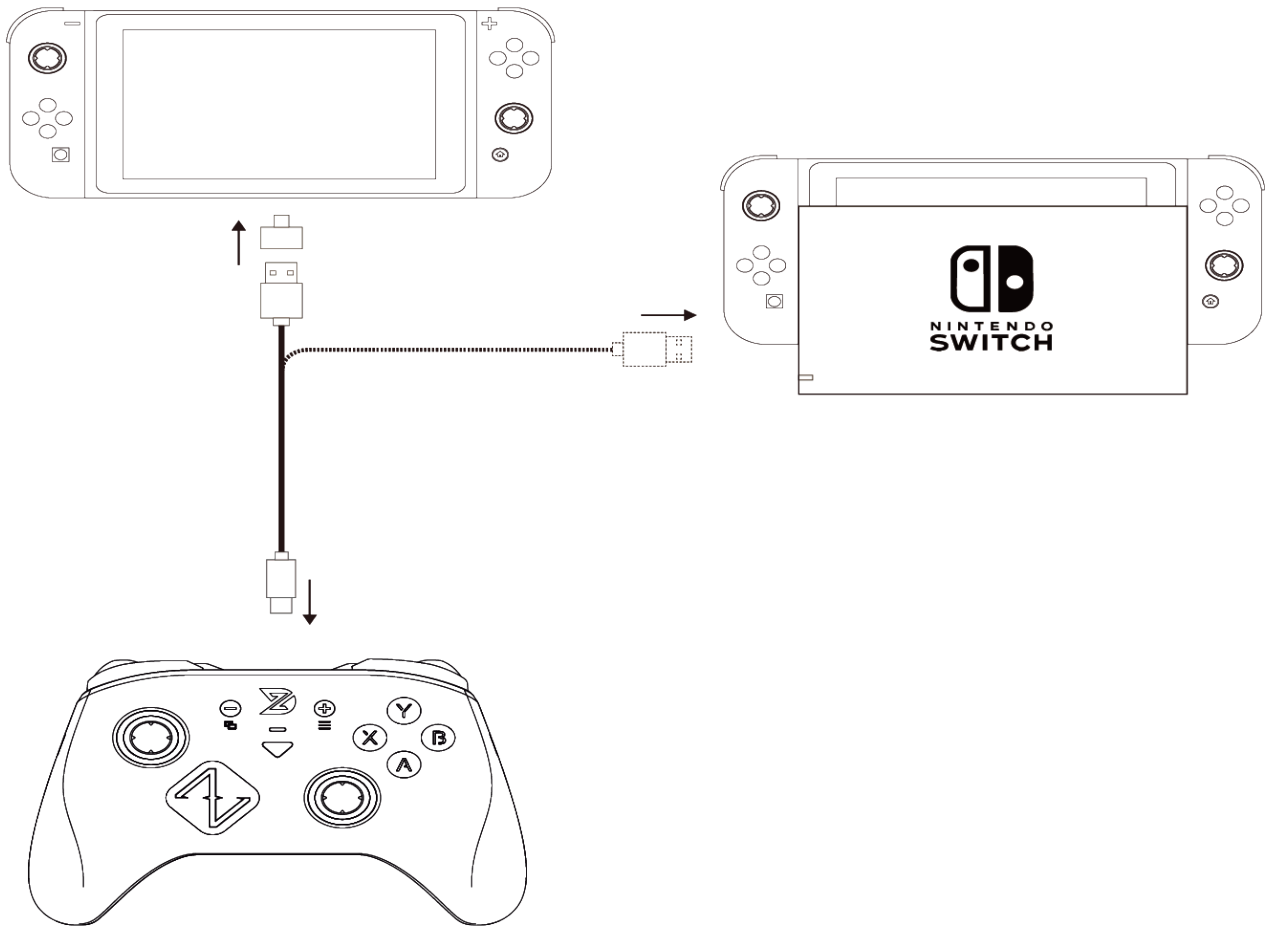
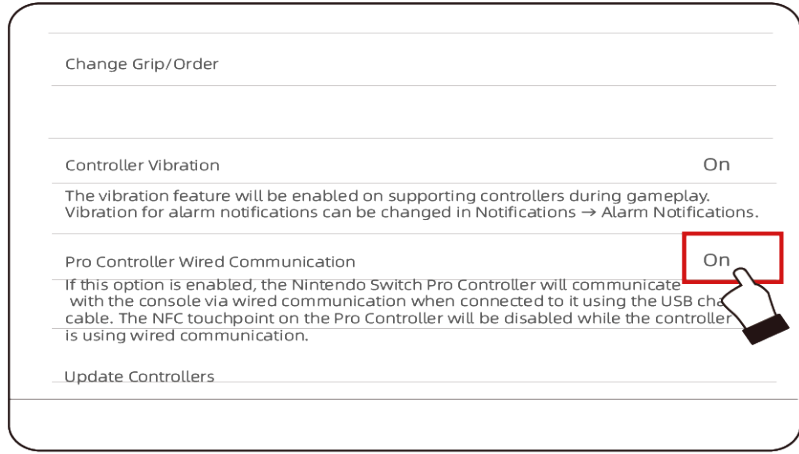
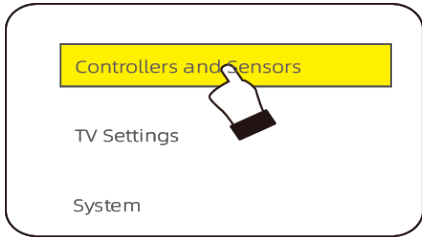
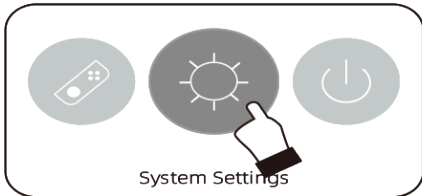

## 4. Mode Switch

When connected to a PC via wired or dongle: Hold **Start + Back** to switch between **Xinput** and **Switch** modes.

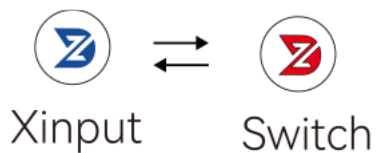

---

## 5. Turbo Mode

Hold **Mode + any button (A/B/X/Y/LB/RB/LT/RT/LS/RS/D-pad)** until the controller vibrates to toggle turbo.

Cycle: Turbo Off → Manual Turbo → Auto Turbo

- **Manual Turbo:** Hold to fire, release to stop.
- **Auto Turbo:** Press once to start, press again to stop.



---

## 6. Calibration

Calibrate to fix abnormal joystick, trigger, or motion control behavior.

### 1. Joystick Calibration

1. Hold **A + D-pad Up**, then hold **Mode** (triangle) for 5 seconds until the indicator flashes rapidly.
2. Rotate both joysticks to their limits 3–5 times.
3. Press **Mode** again to finish.



## 2. Trigger Calibration

1. Hold **X + D-pad Up**, then hold **Mode** (triangle) for 2 seconds until the indicator flashes rapidly.
2. Press both triggers fully 3–5 times each.
3. Press **Mode** again to finish.



## 3. Motion Control Calibration

1. Place the controller flat on a table.
2. Hold **B + D-pad Up**, then hold **Mode (Triangle)** button for 2 seconds until the indicator flashes rapidly.
3. Wait for 5 seconds and then press the **Mode** button again to complete the calibration.



---

## 7. Back Button Setup

This section covers on-controller mapping/macro.

For keyboard mapping, please use the mobile app.

## 1. Button Mapping / Macro

1. Hold **Mode** + **LK/RK/ML/MR** for 2 seconds until the indicator flashes.
2. Press the target button(s) to map or record a macro.
3. Press **Mode** to save.

*Max 20 steps per macro, use the app for advanced settings.*

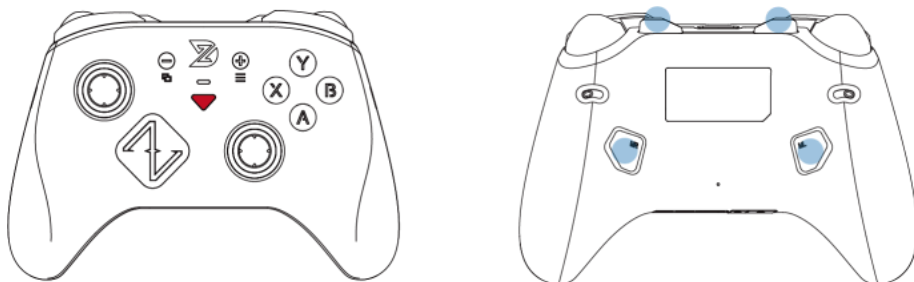

## 2. Clear Mapping / Macro

1. Hold **Mode** + **LK/RK/ML/MR** for 2 seconds until the indicator flashes.
2. Press **Mode** once to clear.

---

## 8. Onboard Profile Switching

The controller stores **4 profiles**; quick switch:

- Hold **Start** + **D-pad Up** for 3 seconds → Profile 1 (red)
- Hold **Start** + **D-pad Left** for 3 seconds → Profile 2 (yellow)
- Hold **Start** + **D-pad Down** for 3 seconds → Profile 3 (blue)
- Hold **Start** + **D-pad Right** for 3 seconds → Profile 4 (green)

Vibration and indicator color confirm a successful switch.

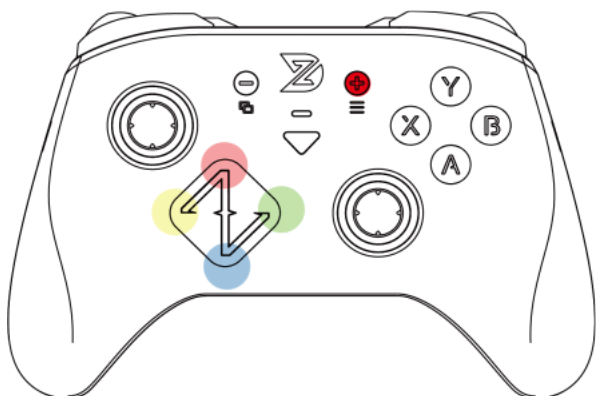

## 9. Dual-Stage Trigger Switch

The controller supports **2 trigger modes** via the trigger lock slider:

- Long-Travel Trigger (Linear)
  - Short-Travel Trigger (Micro-Switch)
- 

## 10. Shortcuts in NS Mode

- Double-click **Mode button**: Screenshot
- Double-click and hold **Mode button**: Record video

